

PIN

INNOVATIVE SOLUTIONS DEVELOPED
BY RUDOLF VON SCHEVEN GMBH
ARMATURENFABRIK UND APPARATEBAU



P R O D U C T I N F O R M A T I O N 0 1 / 2 0 1 5

FLANGE BALL VALVE KFK - BK



**ALOTEC® ALUMINIUM OXIDE -
CERAMIC LINING**



Casting with steel melt

MOULDING SAND. Free-flowing, cohesive and highly mouldable.

Over the millennia, the art of primary forming has been continually refined. Among its crowning achievements are without doubt the bronze statues of classical antiquity. Today, the fascination with this inimitable skill has shifted increasingly to the casting of complex, near net shape components for industry. One such moulding process is sand casting. Regardless of whether it is performed with some manual assistance or as an automated production process, it is particularly eco-friendly, as the excess casting material can be melted down and the prepared mixture of quartz and bentonite returned to the moulding box again. We support this process with a range of state-of-the-art modules, such as ball valves with ceramic components that are highly resistant to abrasion.



Flange ball valve KFK-BK, ductile cast iron, ceramic lining With DIN flange

DN 50 - 125 mm PN 16 bar

Series 25 – PN 10 according to DIN EN 1092-1

Face-to-face lengths DIN EN 558 FTF basic series 27 (alternatively: DIN 3202-1 Series F4)

Temperature range Permissible operating temperature: -10°C to +160°C
Other temperatures on request

Range of use For abrasive materials. In addition, as a matter of principle, the resistance to the flow medium must be ensured.

Technical specification The KFK-BK type ball valve consists of a 2-part body. Up to nominal width DN 100, the half flange is screwed into the half body. From nominal width DN 125, the two body parts are flanged together. The stem is blowout-proof and is provided with a two-fold O-ring seal. Body, screw-in flange and ball are internally coated with the aluminium oxide ceramic material Alotec 92 and the seal is also manufactured from this material.

Please ask separately for requirements that exceed the standard conditions of use listed in this data sheet.

As a matter of principle, the safety information provided in the operating and servicing manual must be observed. The operating and servicing manuals as well as the approval certificates can be downloaded at www.von-scheven.de.

We reserve the right to carry out technical modifications.

Technical data KFK-BK

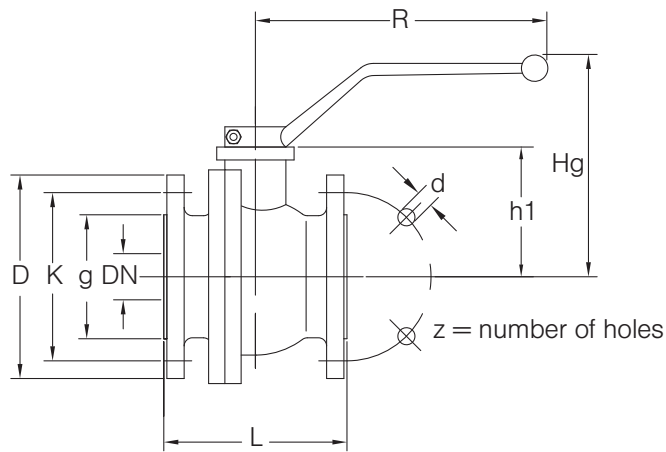
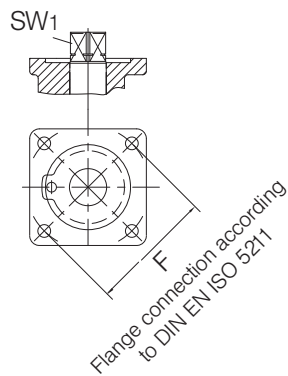

Series 26 (PN 16 according to DIN EN 1092-1)

DN	PN	L	D	g	K	z	d	Hg	R	h1	F	SW1	Weight
mm	bar	mm	mm	mm	mm		mm	mm	mm	mm	DIN EN ISO 5211	mm	kg
50	16	150	165	102	125	4	18	128	250	71	F07	17	13.0
65	16	170	185	122	145	4	18	158	250	101	F07	17	20.5
80	16	180	200	138	160	8	18	182	368	131	F10	22	29.5
100	16	190	220	158	180	8	18	194	358	144	F10	22	36.0
125	16	325	250	188	210	8	18	195	500	163	F10	22	50.0

Example of order: Ball valve type KFK-BK DN 100 with flanged connection PN 16 according to DIN EN 1092-1, internally coated with aluminium oxide ceramic material
KFK-BK 100 26

Parts list KFK-BK

Pos.	Designation	Material*
10	Body	Casting
	Internally coated with aluminium oxide ceramic material	
20	Flange	Casting
	Internally coated with aluminium oxide ceramic material	
30	Ball	Stainless steel
	Internally coated with aluminium oxide ceramic material	
40	Seal	ALOTEC 92
41	O-ring	NBR
42	O-ring	NBR
50	Stop washer	
60	Stem	Steel
80	O-ring	NBR
90	Hand lever	Zinc die-casting, casting
100	O-ring	NBR
130	Sliding ring	PTFE
140	Stop pin	
160	Bolt	

*Standard (can vary according to nominal width), other materials on request.

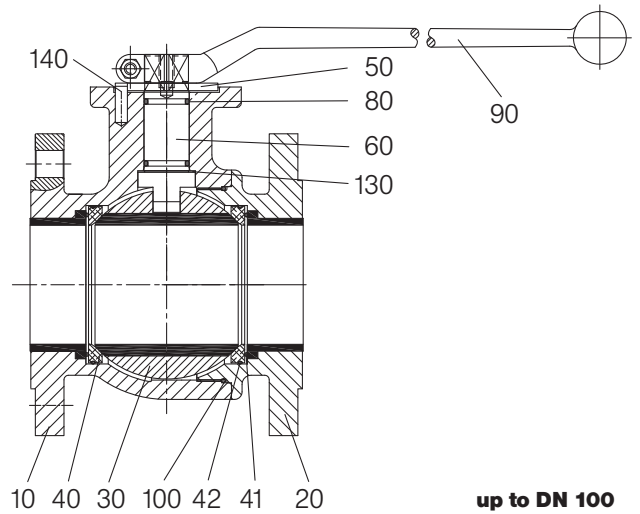

up to DN 100

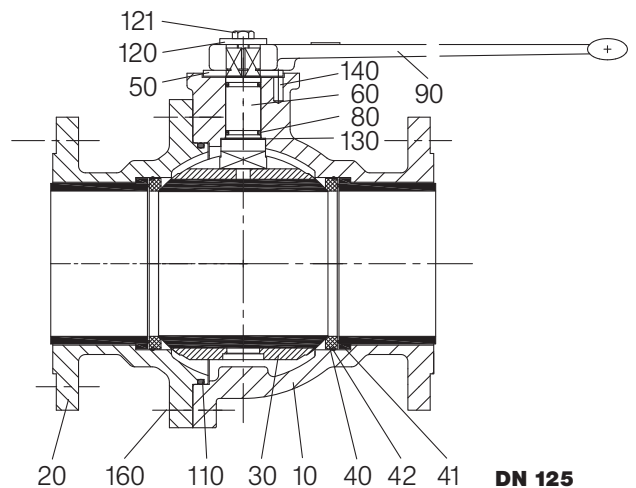

DN 125

P R O D U C T L I N E

2-WAY BALL VALVES WITH THREAD CONNECTION

DN 4-80 mm, PN up to 2.500 bar

2-WAY BALL VALVES WITH FLANGE CONNECTION ACCORDING TO DIN, ANSI, SAE

DN 10-250 mm, PN up to 420 bar

2-WAY BALL VALVES WITH WELD ENDS

DN 8-50 mm, fully welded up to 300 mm, PN up to 400 bar

BALL VALVES FOR MANIFOLD INSTALLATION

DN 6-25 mm, PN up to 500 bar

3-WAY CHANGEOVER BALL VALVES

DN 4-100 mm, PN up to 500 bar

MULTIWAY BALL VALVES

DN 4-25 mm, PN up to 500 bar

BALL VALVES WITH PLUG-IN CONNECTORS (STECK-O, SUPER-STECK-O, SSKV)

DN 6-100 mm, PN up to 500 bar

MINING PORTFOLIO

DN 10-100 mm, PN up to 500 bar

CUSTOMISED SOLUTIONS



Rudolf von Scheven GmbH
Wuppertaler Strasse 10-12
D-45549 Sprockhövel
Phone +49 (0)23 24/97 42-0
www.von-scheven.de

