



Block ball valve for high-pressure acetylene NBAC-C, steel

With female thread

DN 06 / DN 10 mm PN 25 bar

Series 06 – female thread on both sides DIN ISO 228-1

Identification plate According to DIN EN ISO 15615, test report BAM

Temperature range Permissible operating temperatures: -20°C to +65°C

Range of use Ball valve type NBAC-C in nominal widths DN 6 and DN 10 is tested for high-pressure acetylene PN 25 as a shutoff valve and manually actuated quick-closing facility according to DIN EN ISO 15615 and tested by the BAM.

Technical specification Ball valve type NBAC-C is intended for throughflow and/or shutoff by means of 90° operation of the actuating element for the medium of acetylene with the pressure rating PN 25. The design consists of a block body with connector screwed in on both sides. The stem is fitted blowout-proof from the outside.

Option



Safety locking handle, engaging and lockable as an alternative to the hand lever.

Technical data NBAC-C

Series 06

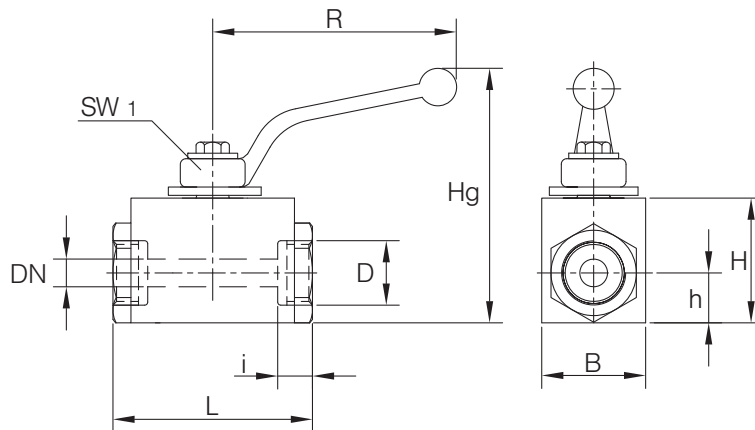
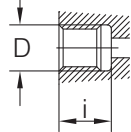

Series 06 (female thread on both sides according to ISO 228 - 1)

Type	DN mm	PN bar	D	i mm	L mm	B mm	H mm	h mm	Hg mm	R mm	SW1 mm	Weight kg
NBAC-C 1006	6	25	G 3/8"	12.5	80	30	40	15	92	112	10	0.5
NBAC-C 1306	10	25	G 1/2"	14.5	100	35	45	18	85	130	10	1.0

Please ask separately for requirements that exceed the standard conditions of use listed in this data sheet.

As a matter of principle, the safety information provided in the operating and servicing manual must be observed!

The operating and servicing manuals as well as the approval certificates can be downloaded at www.von-scheven.de.

We reserve the right to carry out technical modifications.