



Ball valve ESK, stainless steel With female thread

DN 8 - 100 mm PN 63 bar

Series 06 – female thread on both sides according to ISO 7-1
DIN EN ISO 228-1, DIN EN ISO 10226-1

Temperature range Permissible operating temperature: -10°C to +200°C

Materials Housing: 1.4408
Ball: 1.4408
Stem: 1.4404
Ball seals: PTFE
Stem seal: PTFE

Technical specification The 2-part stainless steel ball valve type ESK is suitable for numerous technical applications with a maximum operating pressure of up to 63 bar. The stem seal is ensured by a packing seal.

Technical data ESK

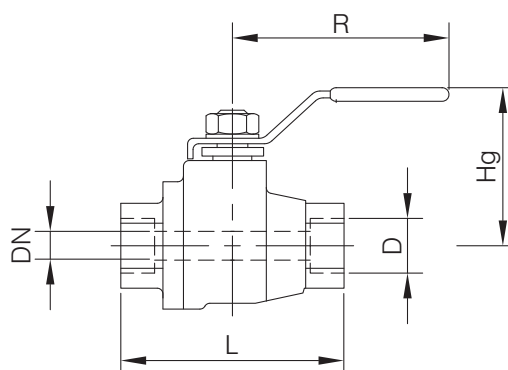

Series 06 (female thread on both sides DIN EN ISO 228-1)

DN mm	PN bar	Clear width mm	D	L mm	R mm	Hg mm	Weight kg
8	63	11.6	1/4"	55	100	50	0.26
10	63	12.5	3/8"	60	100	50	0.28
15	63	16.0	1/2"	75	100	50	0.30
20	63	20.0	3/4"	80	125	60	0.55
25	63	25.0	1"	90	160	70	0.84
32	63	32.0	1 1/4"	110	160	80	1.26
40	63	38.0	1 1/2"	120	190	90	2.00
50	63	50.0	2"	140	190	90	3.13
65	63	65.0	2 1/2"	185	250	145	6.00
80	63	80.0	3"	205	250	145	10.00
100	63	100.0	4"	240	320	175	20.70

Example of order: Ball valve type ESK DN 15 with female thread DIN EN ISO 228-1
ESK 15 06

Please ask separately for requirements that exceed the standard conditions of use listed in this data sheet.

As a matter of principle, the safety information provided in the operating and servicing manual must be observed!

The operating and servicing manuals as well as the approval certificates can be downloaded at www.von-scheven.de.

We reserve the right to carry out technical modifications.