



Flange ball valve KFL-D, stainless steel, long face-to- face length With DIN flange

DN 10 - 50 mm PN max. 320 bar

Series	25 – PN 10 according to DIN EN 1092-1
	26 – PN 16 according to DIN EN 1092-1
	27 – PN 25 according to DIN EN 1092-1
	28 – PN 40 according to DIN EN 1092-1
	29 – PN 63 according to DIN EN 1092-1
	34 – PN 100 according to DIN EN 1092-1
	35 – PN 160 according to DIN EN 1092-1
	36 – PN 250 according to DIN EN 1092-1
	37 – PN 320 according to DIN EN 1092-1

Face-to-face lengths DIN EN 558 FTF basic series 1 (formerly: DIN 3202-1 Series F1)

Temperature range Standard: -10°C to +90°C; DVGW -20°C to +60°C
On request: -50°C to +250°C

Range of use Liquids: Liquids group 1 and 2 according to PED 2014/68/EU Article 13
Gases: Liquids group 1 and 2 according to PED 2014/68/EU Article 13
As a matter of principle, the resistance to the flow medium must be ensured.

Approvals Series 26, 28: DVGW for gas
TÜV-Component mark
Technical instructions on air quality control (TA Luft)

Technical specification The KFL-D type ball valve consists of a block resp. forged body with connector screwed in on both sides. The stem is blowout-proof and, from nominal width DN 32 is provided with a two-fold O-ring seal.

Technical data KFL-D

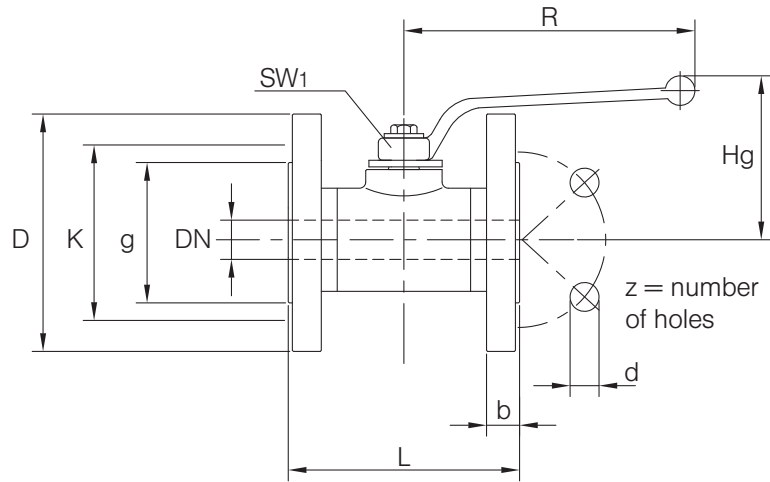
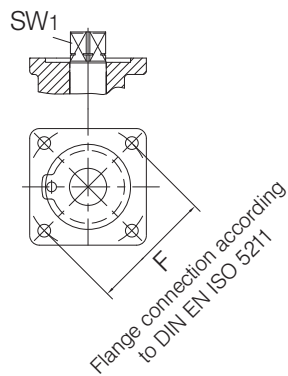

2-way ball valves with flange connection

Flanged ball valves with nominal widths DN 15 to DN 50 of series 28 (PN 40) are supplied, as agreed, with swivelling flanges.

Series 25 (PN 10 according to DIN EN 1092-1)

Series 26 (PN 16 according to DIN EN 1092-1)

Series 27 (PN 25 according to DIN EN 1092-1)

Series 28 (PN 40 according to DIN EN 1092-1)

DN mm	PN bar	L mm	D mm	g mm	K mm	z	d mm	Hg mm	R mm	SW1 mm	Weight kg
10	40	130	90	40	60	4	14	67	130	10	2.0
15	40	130	95	45	65	4	14	69	130	10	2.9
20	40	150	105	58	75	4	14	71	130	10	4.0
25	40	160	115	68	85	4	14	82	160	10	5.3
32	40	180	140	78	100	4	18	117	250	17	7.0
40	40	200	150	88	110	4	18	121	250	17	8.5
50	40	230	165	102	125	4	18	128	250	17	11.0

Series 29 (PN 63 according to DIN EN 1092-1)

DN mm	PN bar	L mm	D mm	g mm	K mm	z	d mm	Hg mm	R mm	SW1 mm	Weight kg
10	63	130	100	40	70	4	14	67	130	10	2.3
15	63	130	105	45	75	4	14	69	130	10	2.7
20	63	150	130	58	90	4	18	71	130	10	3.5
25	63	160	140	68	100	4	18	82	160	10	4.6
32	63	180	155	78	110	4	22	117	250	17	8.6
40	63	200	170	88	125	4	22	121	250	17	10.0
50	63	230	180	102	135	4	26	128	250	17	15.0

Series 34 (PN 100 according to DIN EN 1092-1)

Series 35 (PN 160 according to DIN EN 1092-1)

DN mm	PN bar	L mm	D mm	g mm	K mm	z	d mm	Hg mm	R mm	SW1 mm	Weight kg
10	160	130	100	40	70	4	14	67	130	10	2.3
15	160	130	105	45	75	4	14	69	130	10	2.7
20	160	150	130	58	90	4	18	71	130	10	3.5
25	160	160	140	68	100	4	18	82	160	10	4.6
32	160	180	155	78	110	4	22	117	250	17	8.6
40	160	200	170	88	125	4	22	121	250	17	10.0
50	160	230	195	102	145	4	26	128	250	17	18.0

Series 36 (PN 250 according to DIN EN 1092-1)

DN mm	PN bar	L mm	D mm	g mm	K mm	z	d mm	Hg mm	R mm	SW1 mm	Weight kg
10	250	130	125	40	85	4	18	67	130	10	2.6
15	250	130	130	45	90	4	18	69	130	10	2.7
20	250	150	150	55	105	4	22	71	130	10	3.5
25	250	160	150	68	105	4	22	82	160	10	4.6
40	250	200	185	88	135	4	26	121	250	17	21.5
50	250	230	200	102	150	8	26	128	250	17	25.0

Series 37 (PN 320 according to DIN EN 1092-1)

DN mm	PN bar	L mm	D mm	g mm	K mm	z	d mm	Hg mm	R mm	SW1 mm	Weight kg
10	320	130	125	40	85	4	18	67	130	10	2.6
15	320	130	130	45	90	4	18	69	130	10	2.7
20	320	150	150	55	105	4	22	71	130	10	3.5
25	320	160	160	68	115	4	22	82	160	10	4.6
40	320	200	195	88	145	4	26	121	250	17	21.5
50	320	230	210	102	160	8	26	128	250	17	25.0

Example of order: Ball valve type KFL-D DN 50 with flanged connection PN 40 according to DIN EN 1092-1

KFL-D 50 28

Parts list KFL - D

Pos.	Designation	Material*
10	Body	Stainless steel
20	Flange	Stainless steel
30	Ball	Stainless steel
40	Seal	PTFE, POM
50	Stop washer	Stainless steel, steel
60	Stem	Stainless steel
80	O-ring	FPM
90	Hand lever	Zinc die-casting , steel
100	O-ring	FPM
110	Bolt	
120	Nut	
	Washer	
130	Sliding ring	PTFE
140	Stop pin	

*Standard (can vary according to nominal width), other materials on request.
Due to the design, not all items are used for all nominal widths.

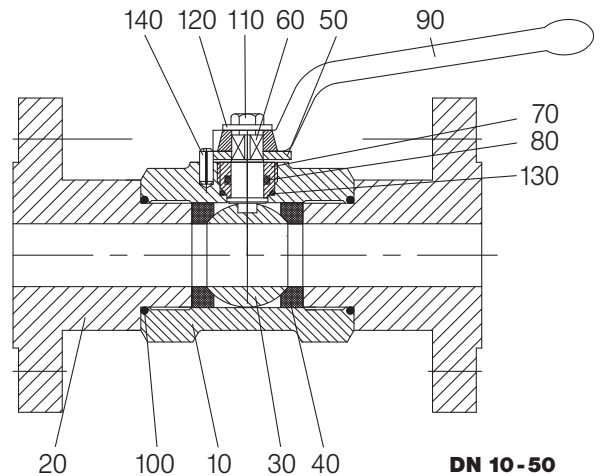

2-way ball valves
with flange connection

Please ask separately, where requirements exceed the standard conditions of use listed in this data sheet.
As a matter of principle, the operating and maintenance instructions, in particular the safety instructions must be observed!
Operating and maintenance instructions as well as the approval certificates can be downloaded at www.von-scheven.de.

We reserve the right to carry out technical modifications.