



# Ball valve with pipe sockets KSAE-C, steel For SAE half flanges

**DN 15 - 80 mm PN max. 420 bar**

**Series** 68 – Connections on both sides for SAE half flanges 3000 psi  
69 – Connections on both sides for SAE half flanges 6000 psi

**Temperature range** Standard: -10°C to +90°C  
On request: -50°C to +250°C

**Range of use** Liquids: Liquids group 1 and 2 according to PED 2014/68/EU Article 13  
Gases: Liquids group 1 and 2 according to PED 2014/68/EU Article 13  
As a matter of principle, the resistance to the flow medium must be ensured.

**Technical specification** KSAE-C type ball valve consists of a block resp. welded body with connector screwed in on both sides for SAE half flanges. Up to nominal width DN 25, the stem is fitted from the outside by means of a fitting. Simple replacement of the stem seal is ensured by the fitting used. A stem seal in accordance with the German Technical Instructions on Air Quality Control (TA Luft) is available as standard from nominal width DN 32 and can be used, on request, up to nominal width DN 25 for an additional charge. Actuators can be attached by means of an extension kit. This retrofit requirement is available as standard from DN 32. Up to nominal width DN 25, this must be stated when placing the order.

Please ask separately, where requirements exceed the standard conditions of use listed in this data sheet.

As a matter of principle, the operating and maintenance instructions, in particular the safety instructions must be observed!

Operating and maintenance instructions as well as the approval certificates can be downloaded at [www.von-scheven.de](http://www.von-scheven.de).

We reserve the right to carry out technical modifications.

## Technical data KSAE-C

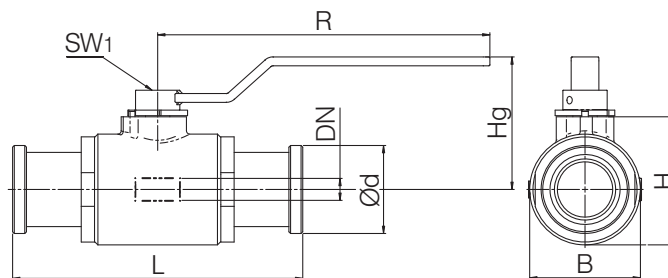

2-way ball valves  
with flange connection

### Series 68 (Connections on both sides with pipe sockets for SAE half flanges 3000 psi)

DN	PN bar	d mm	H mm	B mm	L mm	Hg mm	R mm	SW1 mm
1/2"	210	30.2	45	35	170	85	130	10
3/4"	210	38.1	55	45	190	95	130	10
1"	210	44.4	65	55	210	111	160	10
1 1/4"	210	50.8	65	55	223	111	160	10
1 1/2"	210	60.3	104	Ø 90	260	166	250	17
2"	210	71.4	104	Ø 90	260	166	250	17
2 1/2"	210	84.1	137	Ø133	245	190	300	17
3"	160	101.6	208	Ø155	310	260	350	22

### Series 69 (Connections on both sides with pipe sockets for SAE half flanges 6000 psi)

DN	PN bar	d mm	H mm	B mm	L mm	Hg mm	R mm	SW1 mm
1/2"	420	31.8	45	35	170	85	130	10
3/4"	420	41.3	55	45	190	95	130	10
1"	420	47.6	65	55	210	111	160	10
1 1/4"	420	54.0	65	55	223	111	160	10
1 1/2"	420	63.5	104	Ø90	230	166	300	17
2"	420	79.4	104	Ø90	260	166	300	17

**Example of order:** Type KSAE-C DN type ball valve with connections on both sides with pipe sockets  
for SAE half flanges 6000 psi  
**KSAE-C 20 69**

### Parts list KSAE-C

Pos.	Designation	Material*
10	Body	Steel
20	Fitting	Steel
30	Ball	Steel
40	Seal	POM
50	Stop washer	Steel
60	Stem	Steel
80	O-ring	NBR, FPM
90	Hand lever	Steel, zinc die-casting
100	O-ring	NBR, FPM
130	Sliding ring	PTFE
140	Stop pin	
200	O-ring	NBR, FPM

\*Standard (can vary according to nominal width), other materials on request.  
Due to the design, not all items are used for all nominal widths.

