

## 2/2-way high-pressure block ball valve HBP-C, HBP-D, steel and stainless steel

### For manifold installation

**DN 6 - 25 mm PN max. 500 bar**

Also available as a stainless steel ball valve.  
2/2-way manifold ball valves DN 32 to DN 50 on request

**Temperature range** Standard: -10°C to +90°C  
On request: -50°C to +250°C

**Range of use** Liquids: Liquids group 1 and 2 according to PED 2014/68/EU Article 13  
Gases: Liquids group 1 and 2 according to PED 2014/68/EU Article 13  
As a matter of principle, the resistance to the flow medium must be ensured.

**Technical specification** The HBP-C type ball valve has been specially developed for installation on control blocks. The need to use hoses or piping can be avoided through direct flanging on to the control block.  
Actuators can be attached by means of an extension kit. This retrofit requirement must be specified when placing the order (additional charge).

Please ask separately, where requirements exceed the standard conditions of use listed in this data sheet,  
As a matter of principle, the operating and maintenance instructions, in particular the safety instructions must be observed!  
Operating and maintenance instructions as well as the approval certificates can be downloaded at [www.von-scheven.de](http://www.von-scheven.de).

We reserve the right to carry out technical modifications.

## Technical data HBP-C, HBP-D

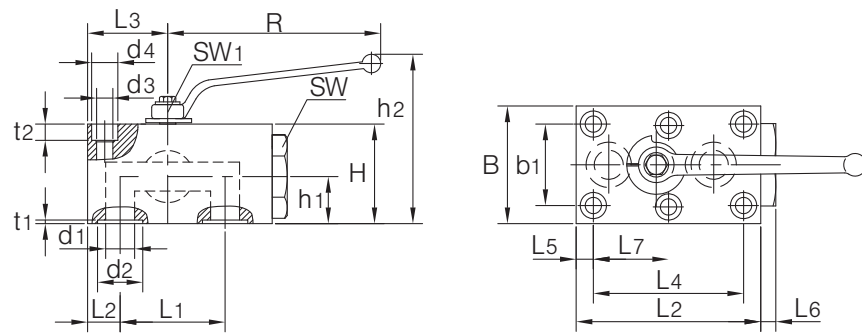

| DN<br>mm | PN<br>bar | L1<br>mm | L2<br>mm | L3<br>mm | L4<br>mm | L5<br>mm | L6<br>mm | L7<br>mm | L<br>mm | b1<br>mm | B<br>mm | H<br>mm | h1<br>mm | h2<br>mm |
|----------|-----------|----------|----------|----------|----------|----------|----------|----------|---------|----------|---------|---------|----------|----------|
| 6        | 500       | 35       | 8.5      | 24.5     | 35       | 8.5      | 5        | -        | 57      | 27       | 40      | 40      | 20       | 72       |
| 10       | 500       | 44       | 10.0     | 30.0     | 55       | 7.5      | 5        | 27.5     | 76      | 40       | 55      | 45      | 20       | 97       |
| 16       | 500       | 58       | 18.0     | 44.3     | 83       | 9.0      | 10       | 41.5     | 102     | 45       | 65      | 55      | 26       | 95       |
| 20       | 320       | 69       | 20.0     | 51.0     | 97       | 19.0     | 19       | 48.5     | 117     | 51       | 70      | 70      | 40       | 110      |
| 25       | 320       | 81       | 24.0     | 60.0     | 115      | 10.0     | 7        | 57.5     | 135     | 60       | 80      | 80      | 46       | 126      |

| DN<br>mm | t1<br>mm | t2<br>mm | d1<br>mm | d2<br>mm | d3<br>mm | d4<br>mm | SW1<br>mm | SW<br>mm | R<br>mm | Weight<br>kg |
|----------|----------|----------|----------|----------|----------|----------|-----------|----------|---------|--------------|
| 6        | 1.8      | 7        | 6.0      | 12       | 6.5      | 11.0     | 7         | 22       | 76      | 0.7          |
| 10       | 1.8      | 9        | 9.5      | 15       | 9.0      | 13.5     | 10        | 27       | 112     | 1.3          |
| 16       | 1.8      | 9        | 16.0     | 25       | 9.0      | 13.5     | 10        | 36       | 130     | 2.4          |
| 20       | 2.7      | 11       | 20.0     | 30       | 11.0     | 18.0     | 10        | 41       | 130     | 4.1          |
| 25       | 2.7      | 11       | 23.5     | 35       | 11.0     | 18.0     | 10        | 50       | 160     | 6.3          |

**Example of order:** HBP-C 25 type ball valve made of steel, DN25 for 2-way manifold installation  
**HBP-C 25**

| Parts list |             | HBP-C            | HBP-D            |
|------------|-------------|------------------|------------------|
| Pos.       | Designation | Material*        | Material*        |
| 10         | Body        | Steel            | Stainless steel  |
| 20         | Fitting     | Steel            | Stainless steel  |
| 30         | Ball        | Steel            | Stainless steel  |
| 40         | Seal        | POM              | POM              |
| 50         | Stop washer | Steel            | Stainless steel  |
| 60         | Stem        | Steel            | Stainless steel  |
| 70         | Fitting     | Brass            | Stainless steel  |
| 80         | O-ring      | NBR              | NBR              |
| 90         | Hand lever  | Zinc die-casting | Zinc die-casting |
| 100        | O-ring      | NBR              | NBR              |
| 110        | Bolt        |                  |                  |
| 120        | Washer      |                  |                  |
| 130        | O-ring      | NBR              | PTFE             |
| 140        | Stop pin    |                  |                  |
| 150        | O-ring      | NBR              | NBR              |
| 160        | O-ring      | NBR              | NBR              |

\*Standard (can vary according to nominal width), other materials on request.  
Due to the design, not all items are used for all nominal widths.

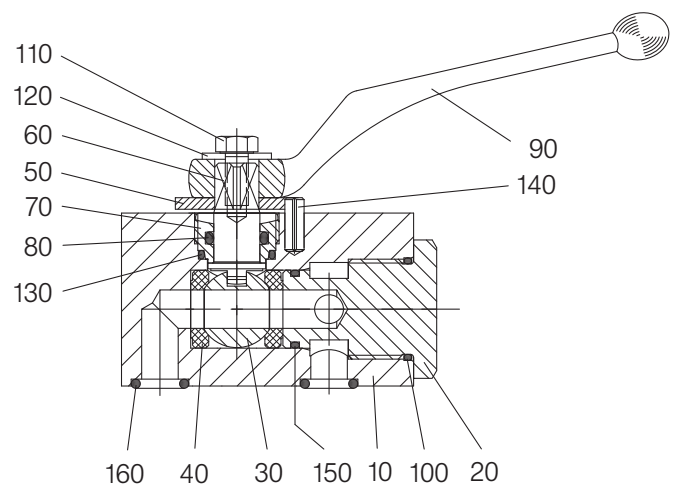

Ball valves for manifold installation