



## High pressure ball valve HKS-C, HKS-D, steel With Steck-O connector

**DN 38 (40) - 80 PN max. 145 bar**

Also available as a stainless steel ball valve.

**Series** 15 – female - male connector  
16 – female - female connector

**Temperature range** Standard: -10°C to +90°C  
On request: -50°C to +230°C

**Range of use** Liquids: Liquids group 1 and 2 according to PED 2014/68/EU Article 13  
Gases: Liquids group 1 and 2 according to PED 2014/68/EU Article 13  
As a matter of principle, the resistance to the flow medium must be ensured.

**Technical specification** HKS-C and HKS-D ball valves are designed as ball valves with fixed female connector. The stem is fitted blowout-proof. Fast fitment in suitable HD line systems is possible by means of the male/female connection variant.

Please ask separately, where requirements exceed the standard conditions of use listed in this data sheet.

As a matter of principle, the operating and maintenance instructions, in particular the safety instructions must be observed!

Operating and maintenance instructions as well as the approval certificates can be downloaded at [www.von-scheven.de](http://www.von-scheven.de).

We reserve the right to carry out technical modifications.

## Technical data HKS-C, HKS-D

### Connection 15

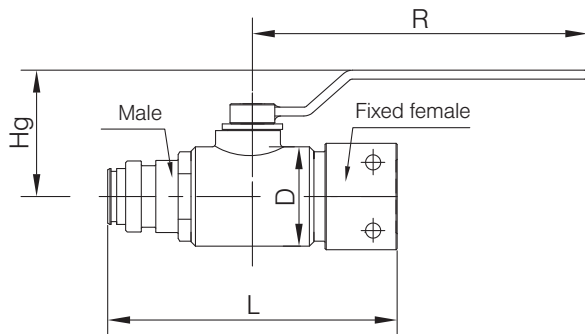

### Connection 16

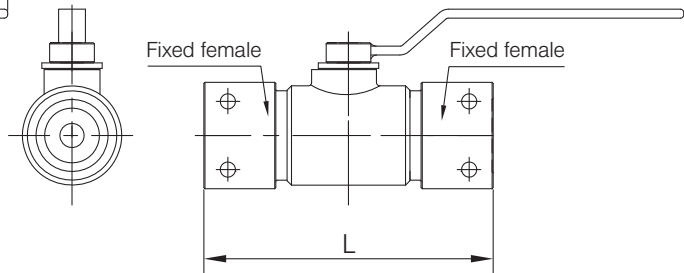

#### Series 15 (fixed female – male)

Steck-O DN	PN bar	L mm	D mm	R mm	Hg mm	Weight kg
38 (40)	145	189	Ø 76	250	117	4.4
51 (50)	130	200	Ø 90	300	121	6.0
63 (65)	70	272	Ø133	300	150	15.0
80	40	278	Ø155	350	182	25.0

#### Series 16 (fixed female both sides)

Steck-O DN	PN bar	L mm	D mm	R mm	Hg mm	Weight kg
38 (40)	145	190	Ø 76	250	117	6.0
51 (50)	130	200	Ø 90	300	120	8.0
63 (65)	70	270	Ø133	300	150	17.0
80	40	276	Ø155	350	182	27.0

**Example of order:** Ball valve type HKS-C of steel with connector: Steck-O DN 80 female – male (series 15) with hand lever **HKS-C 80 15**

#### Parts list

Pos.	Designation	HKS-C Material*	HKS-D Material*
10	Body	Steel	Stainless steel
20	Fitting	Steel	Stainless steel
21	O-ring	NBR	NBR
22	Supporting ring	POM	POM
25	Fitting	Steel	Stainless steel
30	Ball	Steel	Stainless steel
40	Seal	POM	POM
50	Stop washer	Steel	Stainless steel
60	Stem	Steel	Stainless steel
80	O-ring	NBR	NBR
90	Hand lever	Steel	Steel
100	O-ring	NBR	NBR
110	Bolt		
130	Sliding disk	PTFE	PTFE
140	Stop pin		

\*Standard (can vary according to nominal width), other materials on request.  
Due to the design, not all items are used for all nominal widths.

