

# High pressure block multiway ball valve HBDS-C, HBVS-C, HBDS-D, HBVS-D, steel With Steck-O female

**DN 10-25 PN max. 400 bar**

Also available as a stainless steel ball valve.

**Series** 16 – all-round female connector DIN 20043

**Temperature range** Standard: -10°C to +90°C;  
On request: -50°C to +250°C

**Range of use** Liquids: Liquids group 1 and 2 according to PED 2014/68/EU Article 13  
Gases: Liquids group 1 and 2 according to PED 2014/68/EU Article 13  
As a matter of principle, the resistance to the flow medium must be ensured.

**Technical specification** HBDS-C, HBVS-C, HBDS-D and HBVS-D type ball valves consist of a block body with screwed-in connectors. Actuators can be attached by means of an extension kit. This retrofit requirement must be specified when placing the order (additional charge).

Please ask separately, where requirements exceed the standard conditions of use listed in this data sheet.

As a matter of principle, the operating and maintenance instructions, in particular the safety instructions must be observed!  
Operating and maintenance instructions as well as the approval certificates can be downloaded at [www.von-scheven.de](http://www.von-scheven.de).

We reserve the right to carry out technical modifications.

**Technical data HBDS-C, HBVS-C, HBDS-D, HBVS-D**

**Ball holes**

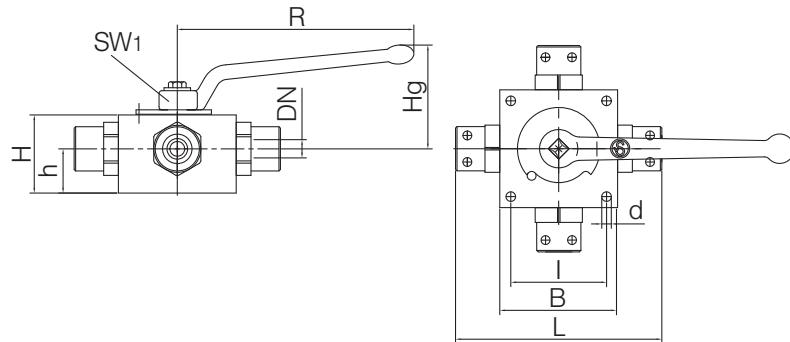
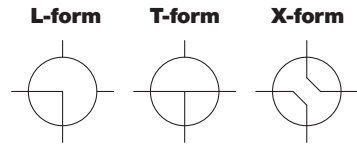

**Series 16**

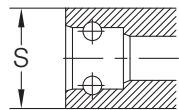

**Series 16** (with female connector DIN 20043)

Steck-O DN	PN bar	S mm	L mm	I mm	B mm	d mm	H mm	h mm	Hg mm	R mm	SW1 mm	Weight kg
10	400	32	150	65	80	6.5	53	30.0	103	160	10	2.6
12	400	36	160	65	80	6.5	60	30.0	103	160	10	3.0
19 (20)	320	40	170	80	100	9.0	60	35.0	122	250	17	4.4
25	250	55	208	85	106	9.0	72	42.5	126	350	22	5.8

**Example of order:** HBDS-C type three-way ball valve made of steel, with female connector DN 12 according to DIN 20043 and ball hole in T-form **HBDS-C 12 16-T**

**Parts list**

Pos.	Designation	Steel Material	Stainless steel Material
10	Body	Steel	Stainless steel
20	Fitting	Steel	Stainless steel
30	Ball	Steel	Stainless steel
40	Sealing piston	POM/brass	POM/brass
60	O-ring	NBR	NBR
70	O-ring	NBR	NBR
80	Fitting	Steel	Stainless steel
90	O-ring	NBR	NBR
100	Hand lever	Zinc die-casting	Zinc die-casting
110	O-ring	NBR	NBR
120	Stop washer	Steel	Stainless steel
140	Stop pin		
160	Supporting ring	PTFE	PTFE
200	Blanking plug	Steel	Stainless steel

\*Standard (can vary according to nominal width), other materials on request.  
Due to the design, not all items are used for all nominal widths.

