



Low pressure mining ball valve MKA-C, steel With male pipe thread

DN 10 - 50 mm PN max. 100 bar

Series MKA 05 – Pipe thread DIN 259 with lock nut – pipe thread DIN 259 with taper
10 – Pipe thread DIN 259 with lock nut – round thread DIN 20029 with taper

Temperature range Standard: -10°C to +90°C
On request: -50°C to +250°C

Range of use Liquids: Liquids group 1 and 2 according to PED 2014/68/EU Article 13
Gases: Liquids group 1 and 2 according to PED 2014/68/EU Article 13
As a matter of principle, the resistance to the flow medium must be ensured.

Technical specification Ball valve MKA-C is specially developed for use in low pressure applications. A male pipe thread is integrated in the housing, whilst a round thread or a male pipe thread with internal taper is screwed in as a connector. The stem is fitted blowout-proof. Hoses or pipeline components can be countered with the standard lock nut.

Please ask separately, where requirements exceed the standard conditions of use listed in this data sheet.

As a matter of principle, the operating and maintenance instructions, in particular the safety instructions must be observed!
Operating and maintenance instructions as well as the approval certificates can be downloaded at www.von-scheven.de.

We reserve the right to carry out technical modifications.

Technical data MKA-C

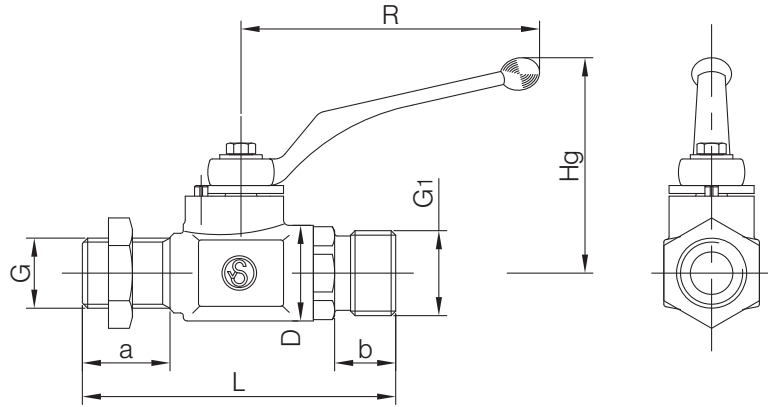

Series 05 (Pipe thread DIN 259 with lock nut – pipe thread DIN 259 with taper)

| DN mm | PN bar | G | G1 | L mm | D mm | a mm | b mm | R mm | Hg mm | Weight kg |
|-------|--------|------|-----------|------|------|------|------|------|-------|-----------|
| 12 | 100 | 3/4" | 3/4" K1:4 | 118 | 36 | 33 | 25 | 113 | 73 | 0.6 |
| 20 | 63 | 1" | 1" K1:2.5 | 127 | 41 | 38 | 22 | 130 | 70 | 0.9 |

Series 10 (Pipe thread DIN 259 with lock nut – round thread DIN 20029 with taper)

| DN mm | PN bar | G | G1 | L mm | D mm | a mm | b mm | R mm | Hg mm | Weight kg |
|-------|--------|--------|------------|------|------|------|------|------|-------|-----------|
| 10 | 100 | 1/2" | Rd 32x1/8" | 116 | 36 | 28 | 23 | 113 | 79 | 0.6 |
| 12 | 100 | 3/4" | Rd 32x1/8" | 116 | 36 | 33 | 23 | 113 | 79 | 0.6 |
| 16 | 100 | 3/4" | Rd 32x1/8" | 118 | 36 | 33 | 23 | 113 | 81 | 0.7 |
| 20 | 63 | 1" | Rd 32x1/8" | 122 | 36 | 38 | 23 | 130 | 89 | 0.9 |
| 20 | 63 | 1" | Rd 38x1/8" | 132 | 41 | 38 | 26 | 130 | 70 | 1.0 |
| 25 | 63 | 1 1/4" | Rd 38x1/8" | 144 | 50 | 41 | 26 | 130 | 74 | 1.4 |
| 25 | 63 | 1 1/4" | Rd 46x1/6" | 149 | 50 | 41 | 30 | 130 | 74 | 1.4 |
| 32 | 25 | 1 1/2" | Rd 55x1/6" | 187 | 75 | 45 | 32 | 250 | 117 | 4.1 |
| 40 | 25 | 2" | Rd 62x1/6" | 196 | 80 | 48 | 35 | 250 | 121 | 4.3 |
| 40 | 25 | 2" | Rd 75x1/6" | 199 | 80 | 48 | 41 | 250 | 121 | 4.7 |
| 50 | 16 | 2 1/2" | Rd 75x1/6" | 205 | 95 | 50 | 41 | 250 | 128 | 5.6 |
| 50 | 16 | 2 1/2" | Rd 90x1/6" | 216 | 95 | 50 | 49 | 250 | 128 | 6.1 |

Example of order: MKA-C type ball valve of steel, DN 16, with pipe thread DIN 259 3/4" with lock nut and with round thread DIN 20029 round 32 x 1/8" with taper 1:3 (for round thread, please also quote dimension G1!)
MKA-C 1610

Parts list MKA-C

| Pos. | Designation | Material |
|------|------------------|------------------|
| 10 | Body | Steel |
| 20 | Fitting | Steel |
| 30 | Ball | Steel |
| 40 | Seal | NBR |
| 50 | Stop washer | Steel |
| 60 | Stem | Brass |
| 70 | Fitting | Brass |
| 80 | O-ring | NBR |
| 90 | Hand lever | Zinc die-casting |
| 100 | O-ring | NBR |
| 110 | Bolt | |
| 120 | Washer | |
| 130 | O-ring | NBR |
| 140 | Stop pin | |
| 150 | Reinforcing ring | Polyamide |
| 160 | lock nut | Steel |

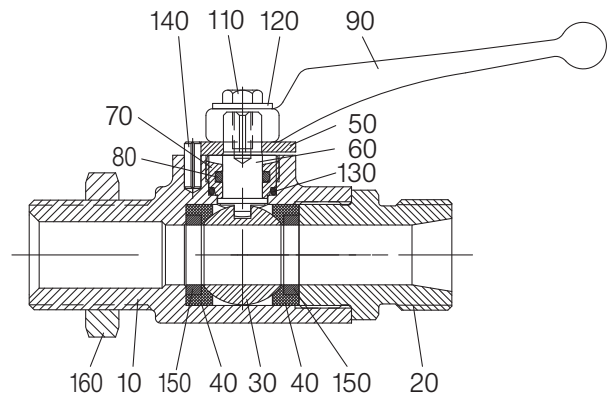

*Standard (can vary according to nominal width), other materials on request.
 Due to the design, not all items are used for all nominal widths.